

## Data sheet

# Non return Valve - Danfoss NVD 805

### Description



- Sealing: metal on elastomere seat
- Using these check valves on networks equipped with piston pumps or compressors is not recommended.

#### Main Data:

- DN 50 - 600
- $k_{vs}$  39,4 - 11269 m<sup>3</sup>/h
- PN 10/16
- Medium:
  - Circulation water, drinking water or chilled glycolic water up to 50%
- Medium Temperature:
  - 10 ... 100°C (EPDM seal), 80°C (NBR seal)
- Mounting between flanges PN10/16
- Compliance with Pressure Equipment Directive 97/23/EC
- Flange drilling according to EN1092-2

#### Features:

- Operating position : horizontal and vertical
- Minimum occupation of space
- Very low head loss
- For pumping, water supply, general industry
- Closing system: double plate with return spring

• Approvals:

### Ordering

"	DN	Kv (m <sup>3</sup> /h)	PN	PFA (bar)	PS (bar)				Code No.
					L1	L2	G1	G2	
2	50	39,4	10/16	16	16	16	16	16	<b>065B7505</b>
2 ½	65	83					15		<b>065B7506</b>
3	80	138					12		<b>065B7507</b>
4	100	250					10		<b>065B7508</b>
5	125	505					0,5		<b>065B7509</b>
6	150	891							<b>065B7510</b>
8	200	1510			10	16	14	<b>065B7511</b>	
10	250	2746						<b>065B7512</b>	
12	300	3936					11	<b>065B7513</b>	
14	350	4254					10	<b>065B7514</b>	
16	400	5000					8	<b>065B7515</b>	
18	450	6547					7	<b>065B7516</b>	
20	500	7800					5	<b>065B7517</b>	
24	600	11269						<b>065B7518</b>	

#### Note:

The indicated pressure for the different categories of fluids (L1/L2/G1/G2) is under no condition a guarantee of use. Therefore, it is essential to validate the use of products under given operating conditions.

### Dimensions

"	A DN	B (mm)	C (mm)	D (mm)	Weight (kg)
2	50	54	60	109	1,2
2 ½	65	54	73	129	1,8
3	80	57	89	144	2,9
4	100	64	114	164	3,9
5	125	70	141	194	5,8
6	150	76	168	220	8
8	200	95	219	275	14
10	250	108	273	330	22
12	300	143	324	380	34
14	350	184	356	440	70
16	400	191	410	491	85
18	450	203	457	541	118
20	500	213	508	596	180
24	600	222	610	698	250

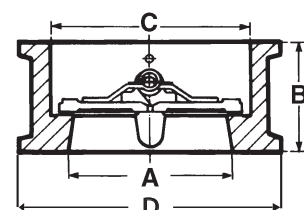

Design

Pos.	Description	Material	EURO	ANSI
1	Casing DN50-150	Cast iron + epoxy	EN-GJL-250	ASTM A 48 35 B
	DN200-300&400	Ductile iron + epoxy	EN-GJS-400.15	ASTM A 536 65-45-12
	*DN350&450-600	Cast iron + epoxy	EN-GJL-250	ASTM A 48 35 B
2	Plates	Aluminium bronze	CuAl10Fe5Ni5	C95400
3	Seal DN50-300&400 DN350&450-600	EPDM	-	-
		NBR (nitrile)	-	-
4	Spring	Stainless steel	X5CrNiMo17-12-2	AISI 316
5	Steam DN50-300&400 DN350&450-600	Stainless steel	X3CrNiMo17-13-3	AISI 316
		Stainless steel	X5CrNi18-10	AISI 304
6	Bearing	PTFE	-	-
7	Eye bolt DN>150	Steel XC15	-	-
8	Plugs	Brass	-	-

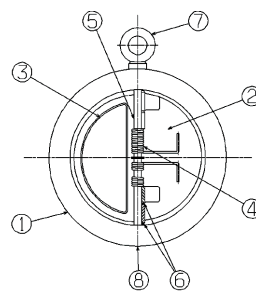

Headloss diagram

DN		Opening pressure (mm)	K <sub>v</sub> (m <sup>3</sup> /h)	ζ
"	(mm)			
2	50	Near 0	39,40	6,30
2 1/2	65		83,00	4,10
3	80		138,00	3,40
4	100		250,00	2,50
5	125		505,00	1,45
6	150		891,00	1,00
8	200		1510,0	1,10
10	250		2746,00	1,10
12	300		3936,00	1,10
14	350		4254,00	1,30
16	400		5000,00	1,60
18	450		6547,00	1,50
20	500		7800,00	1,60
24	600		11269,00	1,60

Direction for use :

- Solid line : Valve completely open
- Dotted line : opening stage of valve

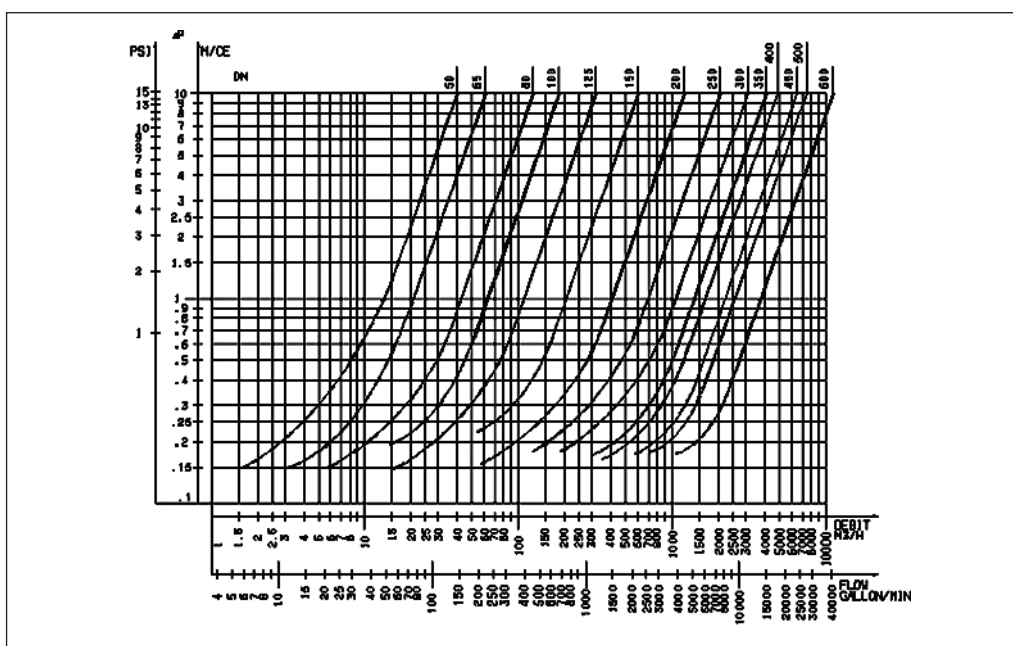

Danfoss can accept no responsibility for possible errors in catalogues, brochures and other printed material. Danfoss reserves the right to alter its products without notice. This also applies to products already on order provided that such alterations can be made without subsequent changes being necessary in specifications already agreed. All trademarks in this material are property of the respective companies. Danfoss and the Danfoss logotype are trademarks of Danfoss A/S. All rights reserved.